

C2 Pump BOM				
Item	Parts #	Description	Qty	Atlas Copco P/N
1	708001	Crankcase	1	1312100877
2	3809-RD	Crank Shaft C2	1	1312100931
3	713000	Fly Wheel C2	1	1312100883
4	711000	Cylinder C1	1	1312100880
5.1	710000	Head C1	1	1312100878
5.2	710001	Right Head C2	1	1312100879
6	731005	OIL SIGHT GLASS C1	1	1312100903
7	10205	Oil Drain Pipe	1	1312100859
8	37001	Oil Drain Pipe Cap	1	1312100861
9	4127-A	Oil Fill Elbow	1	1312100933
10	160004	Plug	4	1312100866
11	727003	Spacer - Inlet Valve C1	4	1312100893
12	727004	Spacer Discharge Valve	6	1312100894
13	S-527-1	Breather Body	1	1312100934
14	12950	Copper Connector	1	1312100860
15	621	Copper Nut	2	1312100856
16	701029	Cover	1	1312100899
17	070116	Gasket Unloader Cover	1	1312100912
18	727136	Retainer Inlet Valve C1	3	1312100898
19	110117	Capscrew-Hex M8x25	28	0147132503
20	130058	Lockwasher 8	12	0333222500
21	727134	Retainer Inlet Valve C1	1	1312100895
22	070172	Gasket Rear Cap	1	1312100920
23	090094	Shim 0.20 Brg. Adj.	1	1312100930
23	090093	Shim 0.10 Brg. Adj.	2	1312100929
24	727135	Retainer Discharge Valve	6	1312100896
25	690	Copper Elbow	1	1312100857
26	070165	Gasket Side Cover C2	2	1312100917
27	020147	Cover Crankcase Side C2	2	1312100904
28	070201	Copper Gasket 8	26	1312100921
29	070163	Gasket Front Cap C2	1	1312100915
30	050159-1	Bearing Cap Rear C1	1	1312100909
31	050159	Bearing Cone Rear C1	1	1312100908
32	050158	Bearing Cone Front C1	1	1312100906
33	050158-1	Bearing Cap Front C1	1	1312100907
34	060068	Seal-Shaft C1	1	1312100911
35	701000	Cap Front C1	1	1312100868
36	110108	Capscrew-Hex M16x120	1	0147149203
37	080029	Key Fly Wheel C1	1	1312100928
38	130057	Lockwasher 16	1	0333224300
39	120060	Nut - Hex M16	1	0261111403
40	070162	Gasket - Cylinder to Crankcase	1	1312100914
41	110107	Capscrew-Hex M10x30	12	0147136303
42	070203	Copper Gasket 10	12	1312100923
43	706003	Aftercooler C2	1	1312100874
44	070170	Gasket Valve Cover	6	1312100919
45	727001	Valve Assy HP Inlet	2	1312100891
46	48633	Safety Valve 250 psi	1	1312100862
47	070167	Gasket Aftercooler	4	1312100918
48	706001	Elbow Aftercooler C2	2	1312100872
49	070161	Gasket - Cylinder Head C1	2	1312100913
50	109999	Capscrew - Skt HD M8x30	4	0211132603
51	110106	Capscrew - Skt HD M8x25	4	0211132503
52	9286	Lockwasher 12	16	0333223600
53	110111	Capscrew-Hex M12x70	16	0147140903
54	70169	Gasket Intercooler	4	1312100927
55	160002	Reducing Bushing C1	2	1312100864
56	727136-2	Cover Valve	6	1312100897
57	722006	Safety Valve 75 psi	2	1312100889
58	110105	Capscrew-Hex M8x90	8	0147133803
59	070204	Copper Gasket B8	14	1312100924
60	706000	Intercooler C1	2	1312100871
61	150017	Aluminum Tube 10x380	1	1312100863
62	712140	Filter Inlet Assembly C1	2	1312100881
63	712114	Filter Replacement Element	2	1312100935
64	705001	Connecting Rod C1	4	1312100869
65	705003	Dipper-Oil C1	4	1312100870
66	050122	Insert Half	8	1312100905
67	050166	Bearing - Wrist Pin Needle C1	4	1312100910
68	200100	Snap Ring - Internal	8	1312100867
69	729000	Wrist Pin LP Piston C1	2	1312100901
70	729006	Wrist Pin HP Piston C1	2	1312100902
71	720000	Piston-LP C1	2	1312100887
72	720002	Piston-HP C1	2	1312100888
73	719064	Piston Ring Set-LP C1	2	1312100885
74	719088	Piston Ring Set-HP C1	2	1312100886
75	070202	Copper Gasket - Valve Seat C1	10	1312100922
76	727000	Valve Assembly-LP Inlet C1	4	1312100890
77	727002	Valve Assy HP/LP Discharge	4	1312100892
78	N/A	1/4" Elbow Street	2	9710601149
-	070246	Gasket Set C2	1	1312100926
-		Overhaul Kit-C2		1312100776

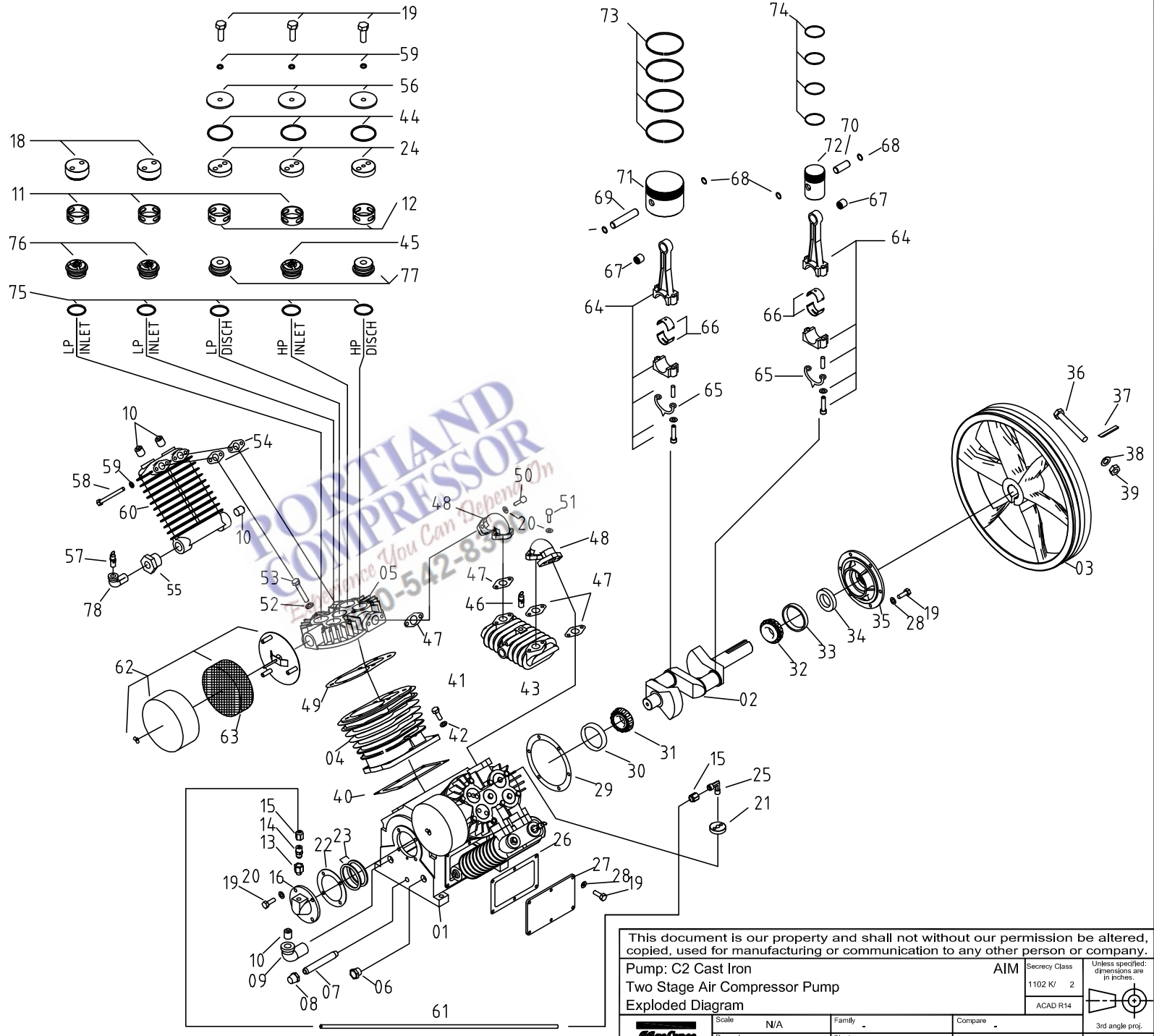

This document is our property and shall not without our permission be altered, copied, used for manufacturing or communication to any other person or company.

Pump: C2 Cast Iron
Two Stage Air Compressor Pump
Exploded Diagram

Scale	N/A	Family	-	Compare	-	AIM	Secrecy Class	Unless specified: dimensions are in inches.
Drawn by	FA	Blank	-	Replaces	-		1102 K/ 2	
Std chd.	XX	Material	SEE DRAWING	Designation	Sheet	1/1		Ed
Transferred from		Des chd.	XX	Prod chd.	XX	Approved	Date	05/18/2011
							1312 2027 00	02

3rd angle proj.
Owner HOL

02	ADDED # 78 ELBOW	120200 00	02/24/12	DD
01	ADDED BOM TO DRAWING	110900 00	07/26/11	DD
ED	DESCRIPTION	DN	DATE	BY